

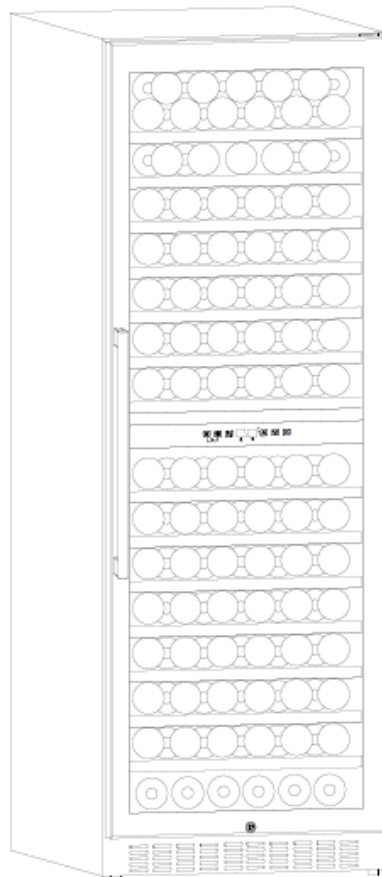

INSTRUCTION MANUAL

WINE COOLER

CW 1700ED AT



PLEASE READ THIS MANUAL CAREFULLY BEFORE USING THIS PRODUCT

PLEASE FOLLOW ALL SAFETY RULES AND OPERATING INSTRUCTIONS

CONTENT

Important Safety Instructions	1-2
Installation.....	3
Product Overview	4
Operation.....	5-7
General Maintenance	8
Troubleshooting.....	9
Technical Specification	10
Warranty & Service	11

Dear Customer,

Thank you for having purchased and given your preference for our product. This manual provides a means to make full use of the features of this appliance. We recommend that you read this manual for the best performance and to extend the life of your appliance.

Please preserve this manual for future use, in the event that doubts arise relating to the operation.

IMPORTANT SAFETY INSTRUCTIONS

DISPOSAL OF OLD APPLIANCES

Before disposing of an old appliance remove any plugs and power supply to ensure that the appliance is safe to be removed.

This appliance must not be discarded as general household waste.

Instead, it should be handed over to the applicable collection point for the recycling of electrical and electronic components Disposal must be carried out in accordance with local environmental regulations for waste disposal.

Disposing of this product correctly helps prevent potential negative consequences for the environment and human health, which would otherwise be caused by inappropriate waste handling of this product.

Warning: When disposing of an old appliance, make sure that the evaporator and the coil are not damaged and there is no gas leak.

BEFORE INSTALLING AND USING YOUR NEW APPLIANCE

Warning: Before turning on the appliance, please leave the door open for 5 minutes to ventilate the cabinet.

Read through the instructions supplied with the appliance – failure to install or use this appliance in accordance with the instruction book may invalidate any warranty.

Do not install this appliance if it has been damaged during transportation. This includes the plug and supply cord.

Please keep these instructions in a safe place for future reference.

The company declines all responsibilities in case of incorrect installation or failure to adopt proper safety measures as stated in this manual.

Note: This appliance is intended to be used exclusively for the storage of wine.

IMPORTANT SAFETY INSTRUCTIONS

- To prevent damage to the door and door gasket, make sure the door is fully opened before pulling out any shelves.
- Do not move the Wine Cabinet when it is loaded with wine, this might damage the appliance.
- If the power cord and plug are damaged they should only be replaced by the manufacturer or a suitably qualified person.

- Never allow children to operate, play with, or crawl inside the appliance.
- Never clean appliance parts with flammable fluids.
- Do not store or use gasoline or any other flammable vapors and liquids in the vicinity of this or any other appliance. This can create a fire hazard or explosion.
- **Warning:** Do not allow the refrigerant circuit to become damaged while using or installing the appliance. Should it become damaged, do not use the appliance until you are instructed to do so by qualified technical personnel. Refrigerant can ignite or cause damage to the eye when leaking.
- Always remember to unplug the appliance before cleaning. When disconnecting from the electricity supply, pull the plug, not the power cord.
- Do not use anything electrical inside the Wine Cabinet.
- All electrical repairs must be carried out by qualified technical personnel. Improper repair may result in a major source of danger for the user and invalidate any warranty.
- Never store anything dangerous inside the appliance, such as combustibles, explosives, strong acid or alkali, etc.
- Always keep any ventilation openings clear of obstruction. Make sure that the plug is accessible
- Only use this appliance for domestic purposes in accordance with these instructions.
- The Wine Cabinet is suitable for storing wine (or other bottled beverages). It is not suitable for storing fresh or frozen foods.
- Children shall not play with the appliance. Cleaning and user maintenance shall not be made by children without supervision.

⚠ Warning: Do not allow the refrigerant circuit to become damaged while using or installing the appliance. Should it become damaged, do not use the appliance until you are instructed to do so by a service engineer. Refrigerant can ignite or cause damage to the eye when leaking.

⚠ Warning: Children shall not play with the appliance. Cleaning and user maintenance shall not be made by children without supervision.

This appliance can be used by children aged 8 years and above and persons with reduced physical, sensory or mental capabilities or lack of experience and knowledge if they have been given supervision or not play with the appliance. Cleaning and user maintenance shall not be made by children without supervision.

Children aged from 3 to 8 years are allowed to load and unload the wine cooler.

To avoid contamination of wine, please take note of the following instructions:

- Opening the door for long periods can cause a significant increase in the temperature in the compartment of the appliance.
- Clean regularly surfaces that can come in contact with bottles and accessible drainage systems.
- Clean water tanks if they have not been used for 48 h; flush the water system connected to a water supply if water has not been drawn for 5 days.
- If the refrigerating appliance is left empty for long periods, switch off, defrost, clean, dry, and leave the door open to prevent mold from developing within the appliance.

The refrigerant of the appliance is R600a, flammable and explosive articles should not be put in or near the cabinet, to avoid the fire or explosion caused.



INSTALLATION OF YOUR WINE CABINET

- Remove the exterior and interior packing.
- **Note:** Before connecting the Wine Cabinet to the power source, let it stand upright for approximately 2 hours. This will reduce the possibility of a malfunction in the cooling system from handling during transportation.
- Clean the interior surface with lukewarm water using a soft cloth.
- Place your Wine Cabinet on a floor that is strong enough to support it when it is fully loaded. To level your Wine Cabinet, adjust the front leveling foot at the bottom of the Wine Cabinet.
- Locate the Wine Cabinet away from direct sunlight and sources of heat (stove, heater, radiator, etc.). Direct sunlight may affect the acrylic coating and heat sources may increase electrical consumption. Extreme cold ambient temperatures may also cause the unit not to perform properly.
- Avoid locating the Wine Cabinet in moist areas.
- Condensation may occur if the ambient humidity is too high. It is normal and doesn't affect the operation of the wine cabinet
- The Wine Cabinet should be positioned at a place where the ambient temperature is between 5°C and 35°C. If the ambient temperature is above or below this range, the performance of the unit may be affected. Placing the appliance in extreme cold or hot conditions may cause the interior temperatures to fluctuate and the range of setting temperatures may not be reached.
- Plug the Wine Cabinet into an appropriate socket. Should the plug require changing, use the instructions as given in the Electrical Requirements section.
- The Wine Cabinet is designed for built-in or free standing.
- For built-in installation, it is necessary to leave a 10cm allowance (5cm on each side) for good ventilation. It is normal for the housing of the cabinet to get heated when it's in operation.

Built-in Installation:

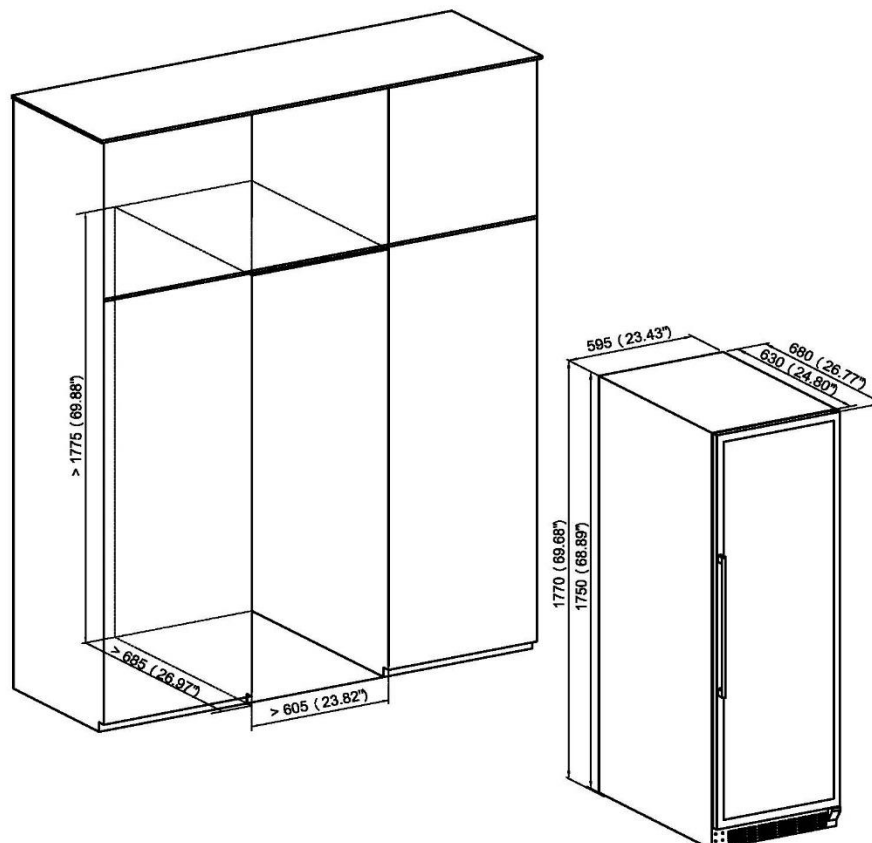

PRODUCT OVERVIEW

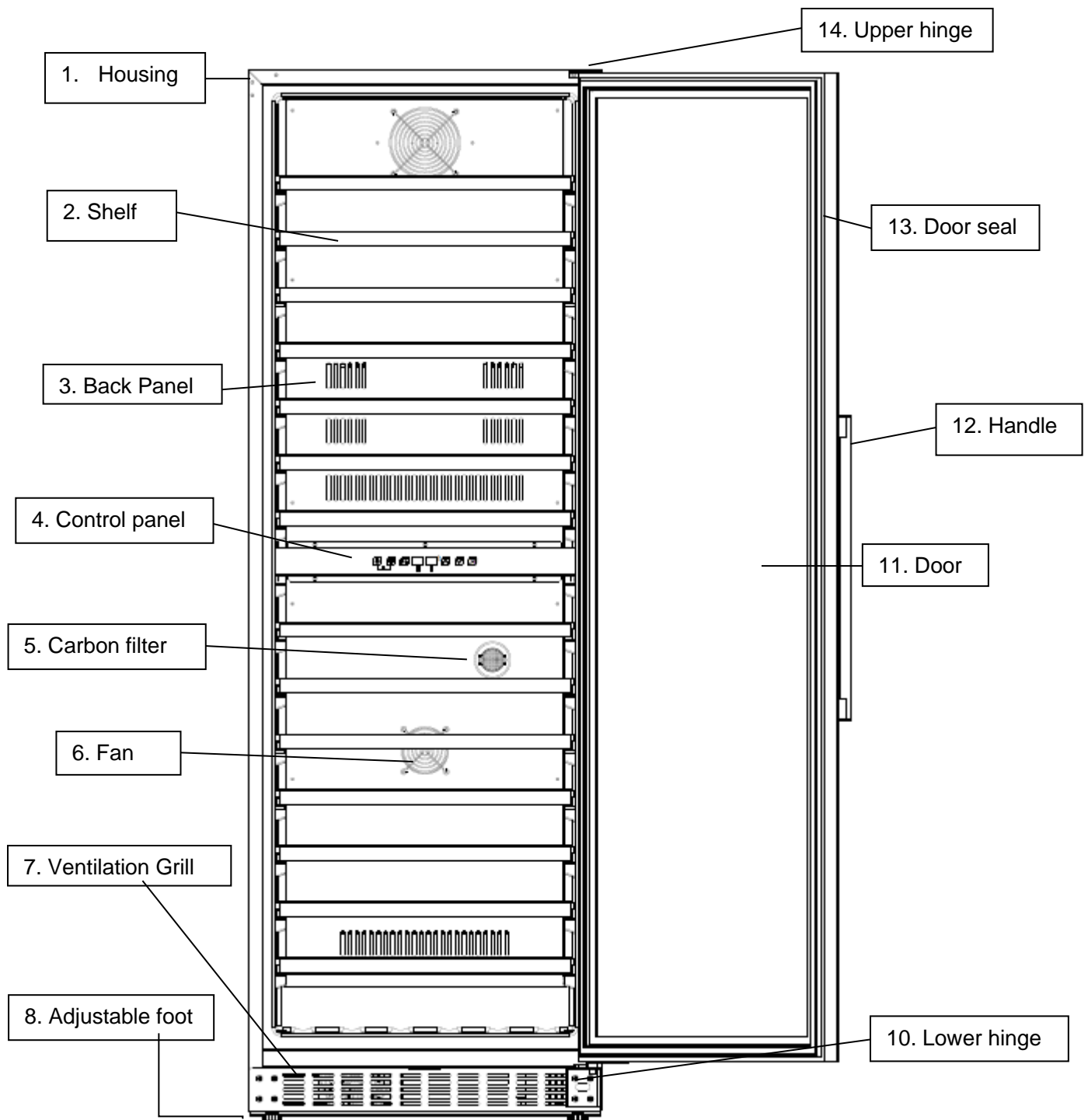

Note:

Shelves, door frame, handle and other accessories could vary depending on models and configuration. The picture is for illustration only. The actual appliance purchased might not be exactly the same as the photo shown above

INSTALLATION OF DOOR HANDLE

The handle is packed separately with screws and is placed inside the wine cooler.

- 1) Pull out the door seal near the door handle to locate the screws hole ①
- 2) Fix the handle ② to the placement using the 2 screws provided ③
- 3) Put the door seal back to cover the screws. Make sure the seal is properly fit ④.

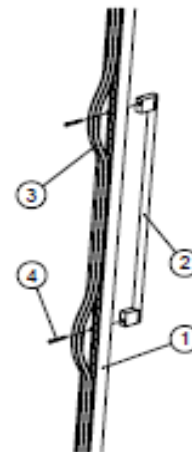

OPERATION

The Wine Cabinet should be placed where the ambient temperature is between 0-35°C (32-95 Fahrenheit). If the ambient temperature is above or below this range, the performance of the unit may be affected. For example, placing your unit in extreme cold or hot conditions may cause interior temperatures to fluctuate. The range of 5-18°C (40-65 Fahrenheit) may not be reached.

Condensation appeared on the outer surface of the glass door of the wine cabinet:

When the water vapor from the air comes into contact with the cold surface of the glass door, the water vapor condenses on the surface of the glass. This will cause a foggy effect or in extreme situations, water can even flow off. It indicates excessive humidity in the environment.

Recommended temperatures for Chilling Wine:

Red Wines:	15-18°C (59-64.40F)
Dry /White Wines:	9-14°C (48.2-57.20F)
Sparkling Wine:	5-8°C (41-46.40F)

Control Panel

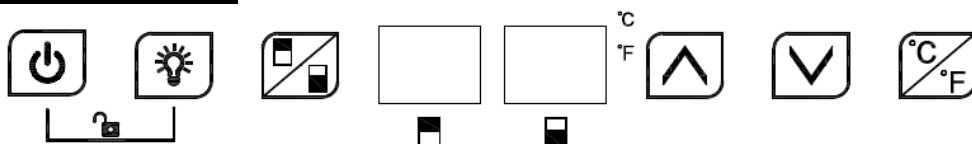

ON/OFF

To turn on or off the appliance, press and hold the key for 3 seconds.

Light

To turn on or off the inner light of the wine cabinet

Zone switch

To select the upper zone or lower zone for adjusting the temperature. Press the key once, the LED display in the selected zone will flash - press the up and down the key to set the temperature.



Press the key once, LED display will show the current set temperature. Each press will increase the temperature by 1°C (warmer). The new temperature will be set after 5 seconds if there is no further pressing on the key. LED display resume to show actual temperature inside.



Press the key once, LED display will show the current set temperature. Each press will reduce the temperature by 1°C(colder). The new temperature will be set after 5 seconds if there is no further pressing on the key. LED display resume to show actual temperature inside.



Child Lock (Combination key)

Press and hold the keys for 3 seconds to activate or deactivate the child lock.



Fahrenheit/Celsius

Press and hold the key for 2 seconds to switch the temperature display between Fahrenheit and Celsius.



1. For both upper and lower zone, the cooling temperature could be set from 5°C-22°C. But lower zone temperature will be equal to or higher than the upper zone.
2. If the unit is unplugged, power lost or turned off, you must wait for 3 to 5 minutes before restarting the unit. If you attempt to restart before this time delay, the appliance will not start.
3. When you use the wine chiller for the first time or restart the wine chiller after having been shut off for a long time, there could be a few degrees variance between the temperature you select and the one indicated on the LED readout. This is normal and it is due to the length of the activation time. Once the wine chiller is running for a few hours everything will be back to normal
4. The actual temperatures may fluctuate depending on whether the interior light is turned on or whether the bottles are located in the upper/middle or lower section
5. Alarm sound: when the system malfunction occurs and alarm sound, press any key on the control panel to cancel the alarm sound.
6. Error code:
When the temperature sensor of upper zone failure occurs, the error code displays E1 for open circuit; E2 for short circuit.
When the defrost sensor failure occurs, the error code displays E3 for open circuit; E4 for short circuit.
When the temperature sensor of Lower zone failure occurs, the error code displays E5 for open circuit; E6 for short circuit.

Wine Storage

- ✧ The appliance is equipped with 14 wooden shelves.
- ✧ Loading capacity: **171** bottles. (standard Bordeaux with 750ml)

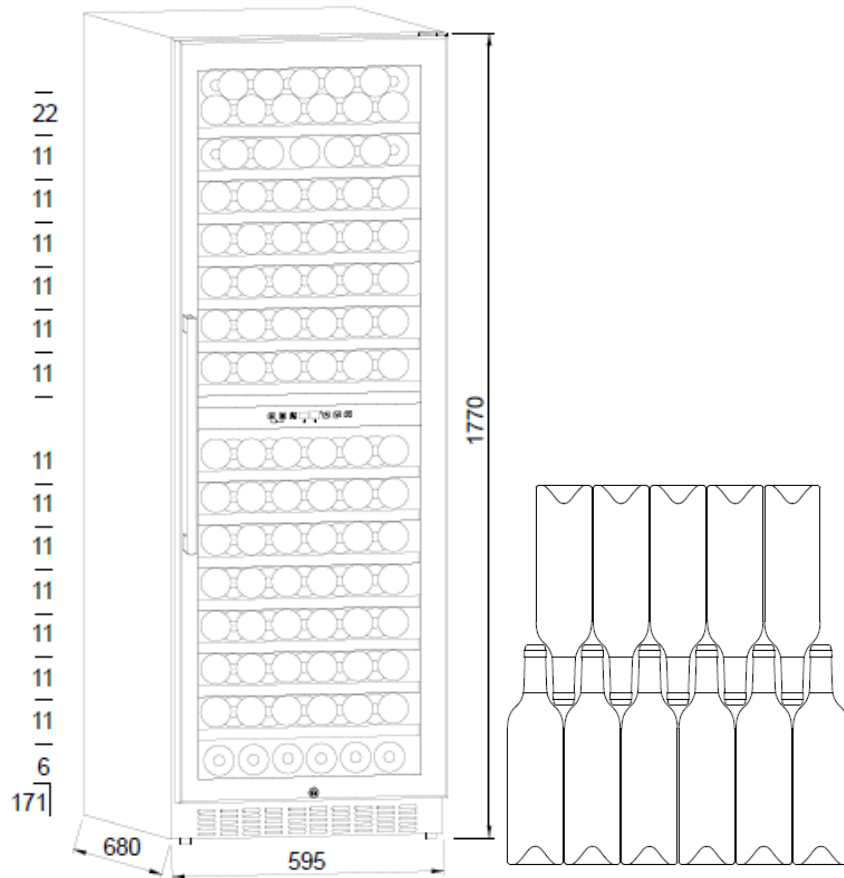

- ✧ Loading capacity varies depending on the arrangement of the wine or depending on the bottle sizes.
- ✧ Each shelf is designed to put 1 or 2 layers of wine. More than 2 layers of the bottle are not recommended.

GENERAL MAINTENANCE

➤ Cleaning Your Wine Cabinet

- Turn off the power, unplug the appliance, and remove all items including shelves and rack.
- Clean the interior with warm water and baking soda solution. The solution should be about 2 tablespoons of baking soda to a quart of water.
- Wash the shelves with a mild detergent solution.
- Wring excess water out of the sponge or cloth when cleaning the control panel or any electrical parts.
- Clean the exterior cabinet with warm water and mild liquid detergent. Rinse well and wipe dry with a clean soft cloth.
- The below items will damage the surface of the wine cooler:

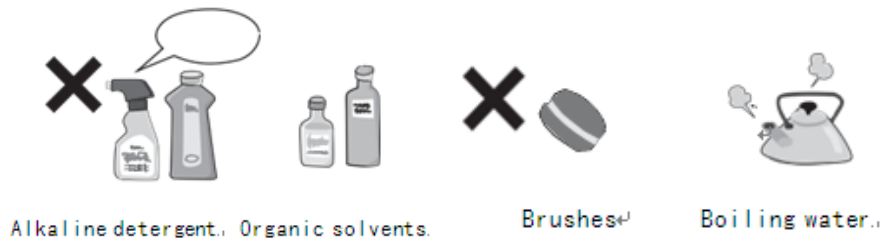

➤ Power Failure

- Most power failures are resumed within a few hours and should not affect the temperature of your appliance if you minimize the number of times the door is opened. If the power is going to be off for a longer period, you need to take the proper steps to protect your contents.

➤ Vacation Time

- **Short vacations:** Leave the Wine Cabinet in operation for a vacation of fewer than three weeks.
- **Long vacations:** If the appliance will not be used for several months, remove all items and turn off the appliance. Clean and dry the interior thoroughly. To prevent odor and mold growth, leave the door open slightly.

➤ Moving Your Wine Cabinet

- Remove all items.
- Securely tape down all loose items (shelves) inside your appliance.
- Turn the adjustable leg up to the base to avoid damage.
- Tape the door shut.
- Be sure the appliance stays secure in the upright position during transportation (or not over 45°). Also, protect outside of the appliance with a blanket or similar item.



➤ Energy Saving Tips

- The Wine Cabinet should be located in the coolest area of the room, away from heat-producing appliances, and out of direct sunlight.

TROUBLESHOOTING

Try the suggestions below before calling the customer service center

PROBLEM	POSSIBLE CAUSE
Wine Cabinet does not operate.	<p>Not plugged in.</p> <p>The appliance is turned off.</p> <p>The circuit breaker tripped or a blown fuse.</p>
The wine Cabinet is not cold enough.	<p>Check the temperature control setting.</p> <p>The external environment may require a higher setting.</p> <p>The door is opened too often.</p> <p>The door is not closed completely.</p> <p>The door gasket does not seal properly.</p>
Turns on and off frequently.	<p>The room temperature is hotter than normal.</p> <p>A large amount of contents has been added to the wine cabinet.</p> <p>The door is opened too often.</p> <p>The door is not closed completely.</p> <p>The temperature control is not set correctly.</p> <p>The door gasket does not seal properly.</p>
The light does not work.	<p>Not plugged in.</p> <p>The circuit breaker tripped or a blown fuse.</p> <p>The bulb has burned out.</p> <p>The light button is "OFF".</p>
Vibrations	<p>Check to assure that the Wine Cabinet is leveled to the floor.</p>
The Wine Cabinet is noisy	<p>The rattling noise may come from the flow of the refrigerant, which is normal.</p> <p>As each cycle ends, you may hear gurgling sounds caused by the flow of refrigerant in your Wine Cabinet.</p> <p>Contraction and expansion of the inside walls may cause popping and crackling noises.</p> <p>The Wine Cabinet is not leveled.</p>
The door cannot close properly.	<p>The Wine Cabinet is not leveled.</p> <p>The door was reversed and not properly installed.</p> <p>The gasket is dirty.</p> <p>The shelves are out of position.</p>
Condensation on the Glass	<p>The door opens too frequently</p> <p>It indicates excessive humidity in the environment – in extreme situations, water can even flow out.</p>

If the problem persists after the above rectifications or if the appliance does not function properly, please contact our customer care center for assistance.

TECHNICAL SPECIFICATION

Product model	CW 1700ED AT
Voltage/frequency	220-240V~/50Hz
Refrigerant/weight	R600a/42g
Volume	415L
Loading capacity	171 bottles
Net weight	90 kg
Unit dimension(WxDxH)	595×680×1770mm
Packing dimension(WxDxH)	660×745×1960mm With wood pallet

Remarks :

1. Net weight includes the weight of shelves
2. Unit dimension is excluding the handle on the door.
3. The manufacturer reserves all the rights to change the above parameters without prior notice. Please refer to the nameplate of your appliance.
4. Loading capacity is calculated based on standard Bordeaux with 750ml.

WARRANTY AND SERVICE

Please get ready the model number of your appliance, date of purchase, and the product issues when contacting our customer care center. For appliances under warranty, proof of purchase is required.

- To activate your warranty, please register your appliance.
- Warranty registration can be done via our website or scan the QR code below

Website

<https://shop.casa.sg/E-Warranty>

QR Code

Scan the QR Code below. It will redirect straight to our “Warranty Registration” page.



Casa (S) Pte Ltd. reserves the rights to the final interpretation of the content of this manual. The customer will not be notified in the event of any amendments to the content.

The manufacturer and agent decline all responsibilities in the event of damage caused by improper, incorrect, or illogical use of the appliance.

For customer care / after-sales service [Singapore], please contact

Casa (S) Pte Ltd
15, Kian Teck Crescent, Singapore 628884
Telephone: +65 62680077
Fax: +65 6898 0510
Email: service@casa.com.sg